



HE-330S/W Remote Control Sockets

V1.0

The HE-330 contains a single HE-300 remote control and 3 HE302 self learning remote control receiver sockets, max load 3000W(resistive).

Pairing/Deleting with Remote Control:

Up to Six remote control units can be paired with each receiver socket. To program a socket insert the unit into a plug socket and switch on the power, now press the "Learn" button. The LED will start to flash, now press the selected "On" button on the remote control, the LED will stop flashing. The units are now paired together place your selected electrical product into the receiver socket, you can test this by pressing the selected "ON/OFF" button.

Deleting Remote Control:

To delete a remote control that has been paired with a Receiver Socket or Module, simply press the "Learn" button. The LED will start to blink; press the "Off" button on the remote control, the LED will blink twice to confirm that the remote control has been removed from the receiver sockets memory.

Remote Socket reset:

To delete all the remote control units paired with a Receiver Socket or Module, hold the "Learn" button for more than 6 seconds, the LED will start to blink continuously. Press and hold "Learn" button for a further 6 seconds, the LED will blink twice to confirm the deletion of all remote controls from the receiver memory.

Group Setting G:

The group setting allows you to switch "On/Off" multiple receiver sockets/modules in one simple press. To set a receiver to the group setting, set the receiver into the learn mode as normal (see instructions Learn Mode) and press group(G) On.

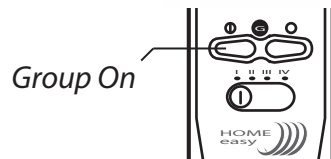

The socket will now switch On/Off with the group buttons; this stays the same even if the group slide switch is on I, II, III or IV. The receiver sockets/modules can still be used individually using the normal On/Off buttons.

Group Setting:

The HE300 remote control transmitter can be paired with up to 16 separate receiver units, using the Group setting function.

- Group 1 - Function 1, 2, 3, 4 (Default Setting)
- Group 2 - Function 5, 6, 7, 8
- Group 3 - Function 9, 10, 11, 12
- Group 4 - Function 13, 14, 15, 16

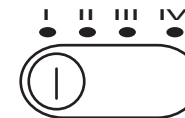

Changing Battery:

The HE-300 uses a single CR2032 battery: Remove the battery holder from the bottom of the remote control.

Remove the battery from the holder and replace with new, making sure the polarity matches the internal markings.

Product Specification:

Remote Control: HE-300
 Battery: 3v Cr2032
 Range: 30 Metres (Open Distance)
 Frequency: 433.92MHz
 Indoor Use Only

Receiver Socket: HE-302
 Input: 230V ~ 50Hz
 Max Load: 3000W (Resistive Load)
 Frequency: 433.92MHz
 Indoor Use Only

Warning: Never Exceed the Product

Help: Occasionally interference from receiver sockets plugged into adjacent wall sockets or used with transformers (low voltage products) can affect the operating

Try placing one of the receiver sockets in another wall socket. For low voltage products, place the transformer as far away from the receiver socket as possible.

RF Range The radio signals operating distance is reduced when the signal has to pass through walls. The radio signal achieves a range of 30m inside a building; this can be reduced depending on the type of material

Contact: Helpline: 0845 2301 231

C H Byron
 34, Sherwood Rd
 Aston Fields
 Bromsgrove
 B60 3DR

Tel: 0845 2301231
 Fax: 01527 557701
 Web: www.chbyron.com
 E-mail: support@chbyron.com

Byron		433MHz					
R&TTE APPROVED							
CE 0560							
A	✓	IRL	✓	UK	✓	M	✓
B	✓	L	✓	BG	✓	N	✓
DK	✓	NL	✓	CZ	✓	SK	✓
FIN	✓	P	✓	EST	✓	SLO	✓
F	✓	E	✓	H	✓	CH	✓
D	✓	E	✓	IS	✓	PL	✓
GR	✓	S	✓	LV	✓	RO	✓
LT	✓						

CH Byron Electrical United Kingdom. www.chbyron.com

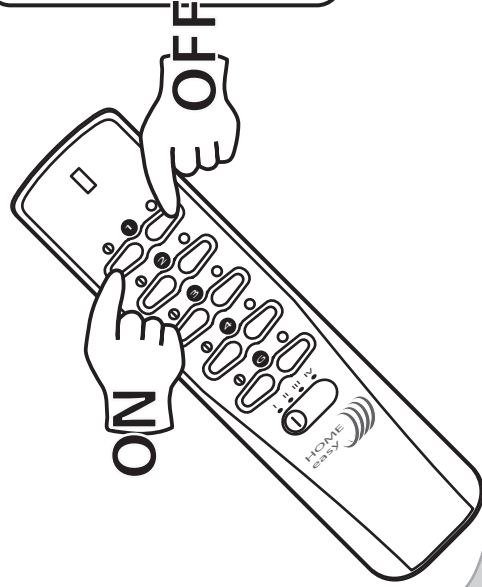
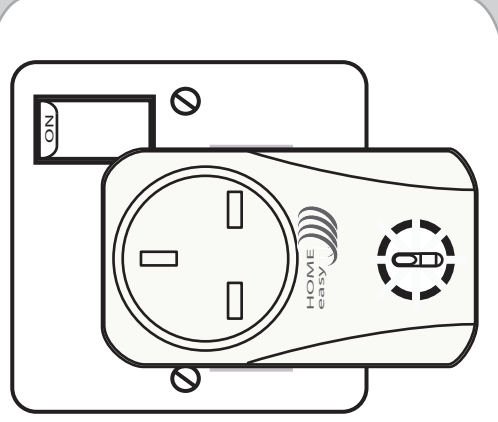
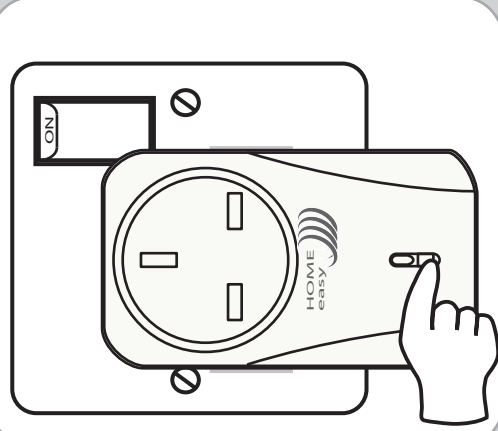
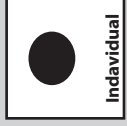
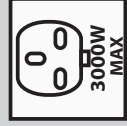
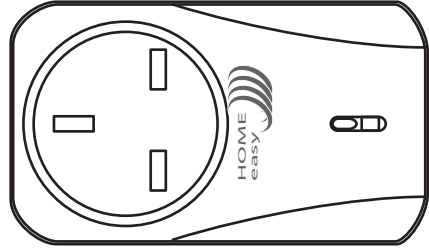
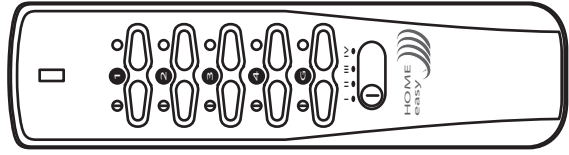

**3000W
MAX**